

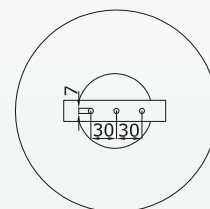

DK 30

The horn speakers of the DK 30 series are particularly applicable for the reproduction of announcements and warnings. Due to their excellent capability and enormous sound pressure they are perfectly suitable for indoor as well as for outdoor use. The model with 2 cable glands allowed to loop in loop out the cabling thus avoiding the need for an additional junction box.

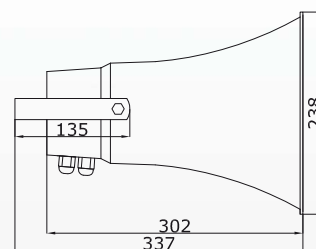

Specifications

Type	DK 30
Loading rate	30 W
Frequency range (-10dB)	400 - 7 500 Hz
SPL 1W/1m	110 dB
SPL Pmax/1m	125 dB
Radiation angle 1.000 Hz (-10dB)	110°
Transformer	100 V, 30/15/7,5/3,75 Watt
Dimensions	Ø238 x 302 mm
Weight	2,3 kg
Material	ABS Plastic
Connection	clamp
Colour	RAL-7035 Grey
Protection IP	66
Packing unit	12