

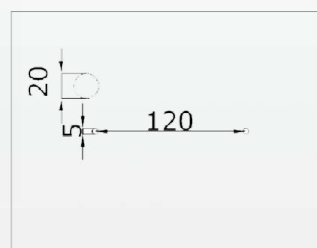

## WAL 165/6 LR

Characteristic for the attractive WAL series is the premium MDF-wood housing whose robustness is featured by the IP 54 degree of protection. The integrated 165 mm full range chassis guarantees an excellent frequency response and is suitable for the acoustic irradiation in almost every room. Integrated in the WAL series the WAL 165/6 LR is additionally equipped with a potentiometer.

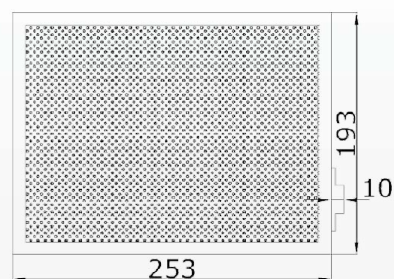

### Specifications

Type	WAL 165/6 LR
Loading rate	6 W
Chassis-type	165 mm full range
Frequency range (-10dB)	140 - 19 700 Hz
SPL 1W/1m	98,2 dB
SPL Pmax/1m	106 dB
Radiation angle 1.000 Hz (-10dB)	180°
Transformer	100 V, 6/3/1,5/0,75 Watt
Dimensions	253 x 193 x 83 mm
Weight	1,6 kg
Material	MDF- wood housing
Connection	2 -pole compression clamp
Colour	RAL-9010 White/special colouring is possible for a surcharge
Protection IP	54
Packing unit	8