

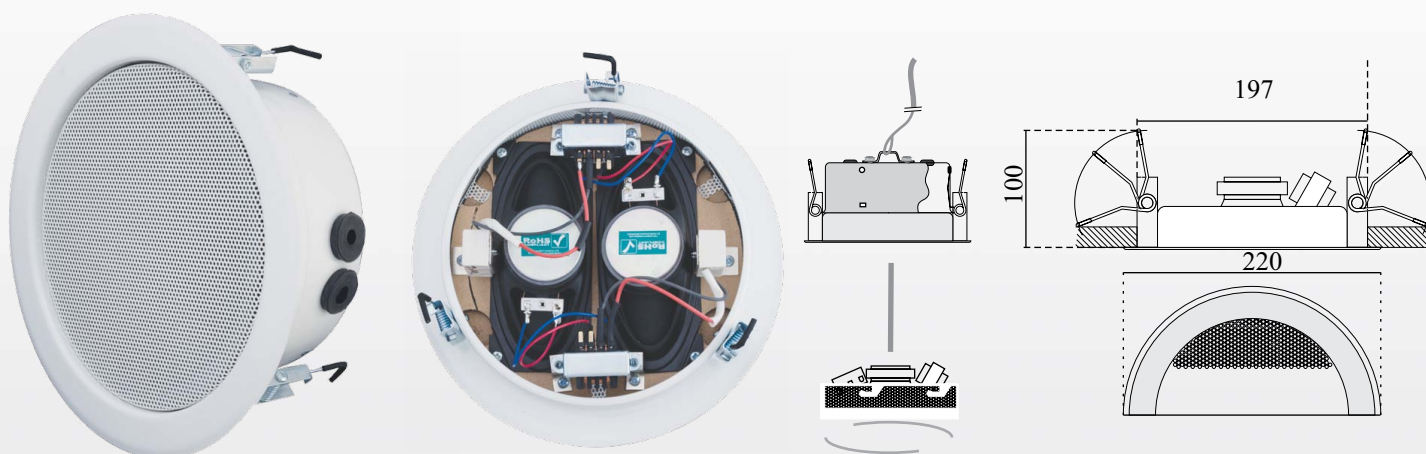

DEL 200/10-A/B PP

The DEL 200/10-A/B PP is equipped with two independent transformer / loudspeaker- combinations and allows loudspeaker's supply by two different wires. By the traditional alternating division of the loudspeakers in the A- and B- line, the breakdown of one line causes an unsupplied area between the next active loudspeaker of the redundancy. Using the loudspeakers of the A/B series the A- as well as the B- line is existing in every mounting position. Accordingly the level loss in the considering area is lighter. If one line fails there will be a higher comprehensibility of speech and security compared to an alternating configuration. The classic appearance and the brilliant acoustic features make this ceiling speaker suitable for diverse acoustic irradiations. The exceptional spring mounting with cropped leg springs guarantees an outstanding rapid ceiling installation.



Specifications

Type	DEL 200/10 - A/B PP
Certificat	EN 54-24:2008 - 1438/CPD/0221
Loading rate	10 W
Chassis-type	2 x 164/69 mm full range
Frequency range (-10dB)	220 - 16 800 Hz
SPL 1W/1m	96,7 dB
SPL Pmax/1m	111,8 dB
Radiation angle 1.000 Hz (-10dB)	H: 180°/165°/135°/97,5° V: 180°/160°/110°/92,5° 100 V, 2 x
Transformer	10/6/3/1,5 Watt
Dimensions	Ø265 x 100 mm
Cut out	Ø236 mm - Ø250 mm
Weight	2,5 kg
Material	powder-coated, steel panel
Connection	3-pole ceramic clamp
Colour	RAL-9010 White/special colouring is possible for a surcharge
Packing unit	12