

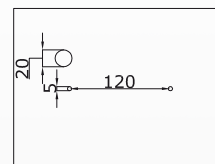

PARTNER sp. z o.o.

WAL 165/6-A/B PP WAL 165/6-A/B PP1

WAL 165/6-A/B PP – this elegant, rectangular wall A/B-line loudspeaker is made of a high-grade MDF and it is an ideal solution for both music and voice evacuation announcements. WAL 165/6-A/B PP is equipped with two independent full-range speakers and 100V transformers to enable operation of 2 separate speaker lines in one loudspeaker enclosure. This is a perfect solution to limit the number of loudspeaker “boxes” in the project and make installation more economic. Also from the security point of view this solution ensures the highest standard – in case of one speaker failure, the second one will ensure the same independent operation. The connection unit has two 3-pin ceramic terminal blocks with thermal fuses. The loudspeaker has IP 54 rating. It is optionally offered in PP1 version – it means instead of ceramic block and thermal fuse it is equipped just with a 2-pin plastic connection blocks.

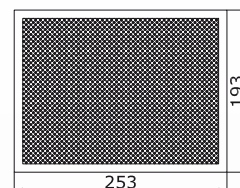
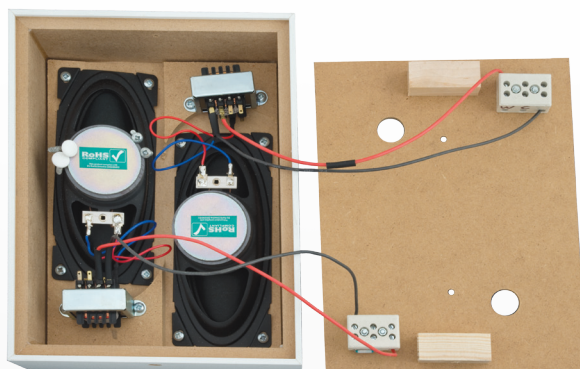

Model	WAL 165/6-A/B PP	WAL 165/6-A/B PP1
Type	wall	
Application	wall	
Certificate Number	1438-CPR-0800	
Speaker Type	2x 164/69 mm full-range	
Rated power [W]	2x6	
Driver impedance [Ω]	8	
Impedance 100V [Ω]	1561/3113/6003/11670	
Tappings 100V [W]	2x 6/3/1,5/0,75	
Frequency Range (-10dB) [Hz]	110-16900*	
SPL 1W/1 m [dB]	91**	
SPL Pmax/1 m [dB]	99**	
Sensitivity 1W/4 m EN 54-24 [dB]	73,5 (single), 76,2 (double)	
SPL max (rated noise power/4 m) EN 54-24 [dB]	78,7 (single), 84,5 (double)	
Dispersion -6dB, 500 Hz/1 kHz/2 kHz/4kHz [°]	H: 210/165/100/90, V: 215/205/160/95 (single)	
	H: 195/135/75/45, V: 195/150/70/35 (double)	
Connection PP/PP1	2x 2x3 pole ceramic cube, 2x 2x2 pole connector	
Temperature range [°C]	<-10, +55>	
Type A/B/C	A	
IP Rating according to EN 54-24 / IP Rating***	21C/54***	
Dimensions [mm]	253x193x83	
Weight [kg]	2,2	
Material	MDF	
Colour	RAL 9010	
Packing Unit	8	

* measured in institute other than BIP CNBOP - following PN-EN 60268-5:2005

**parameter calculated

***tested in institute other than BIP-CNBOP

www.partneraudio.eu

